

**OREGON PUBLIC LAND CORNER REPORT / RESTORATION REPORT**  
Tillamook County Surveyor's Office

BOOK 8 201

<b>SECTION: 7</b>	<b>TOWNSHIP: 1 South</b>	<b>RANGE: 9 West</b>
<b>COUNTY: Tillamook</b>		<b>DATE: 4/18/2024</b>
<b>CORNER DESIGNATION:</b> The 1/4 corner common to sections 7 and 18, Township 1 South, Range 9 West; Willamette Meridian		<b>(Please check one)</b>
		<input type="checkbox"/> Condition Report Only
		<input type="checkbox"/> Restoration
		<input checked="" type="checkbox"/> Rewitness
		<input type="checkbox"/> Unrecorded
		<input type="checkbox"/> Reset at surface
		<input type="checkbox"/> Referenced Out

**Previous Rewitnesses, Restorations and Surveys, etc...** G.L.O. 15 9W PG. 70 (1857), Rewitness bk. 1 pg. 10 (1887), Rewitness bk. 10 pg. 11 (1887), A-271 (1916), B-535 (1967), Rewitness bk. 3 pg. 226 (1967), A-5301 (1985), Rewitness card #190 (1986)

**History, condition, and sources:** The Corner was first established by Henry Meldrum DS in 1857 he set a post for the corner and established 2 bearing trees. In 1887 (Rewitness bk. 10 pg. 11) Tillamook County Surveyor Hayes reset a post for the corner and established 2 bearing trees. In 1967 (Bk. 3 pg. 226) Harold Russell restored the missing corner with a 1.5" x 36" galvanized iron pipe and 3" bronze cap and established 3 new bearing trees and a 4"x4" white painted cedar post. In 1985 (Rewitness card # 190) the Tillamook County Survey office found the monument in good condition and encased the monument in an 8" cylinder of concrete with a hat section post and a yellow metal location tag. In 2024 (field book MR 16 pg. 27-28) the Tillamook County Survey office found a 3" Oregon State Board of Forestry brass cap in concrete marked "1/4 S7 S18 1967 RS 707" as shown hereon. The record accessories are listed below.

- Not Found: (Rewitness card #190) 16" hemlock stump with scribing visible S 85.5° W 18.4'
- Not Found: (Rewitness card #190) 18" hemlock stump bottom part of face overgrown N 29° E 47.3'
- Found: (Rewitness card #190) 14" fir stump S 68° E 6.4' NOW badly decayed stump
- Found: (Rewitness card #190) 4" x 4" white cedar post burnt NW 1.0' Now badly decayed remains lying next to monument
- Found: (Rewitness card #190) 60" hat section post with yellow metal location tag N 50° E 1.5'

**New accessories set:**

- 20" Hemlock S 03° W 16.9' scribed "T1SR9S18BT" with nail and washer between the B & T, with a yellow metal location tag
- 21" Hemlock S 59°E 27.4' scribed "T1SR9WS18BT" with nail and washer between the B & T, with a yellow metal location tag
- 19" Hemlock S 61° E 33.4' scribed "T1SR9WS7BT" with nail and washer between the B & T, with a yellow metal location tag
- 19" Hemlock N 17° W 34.6' scribed "T1SR9WS7BT" with a nail and washer between the B & T, with yellow metal location tag

**Pictures of Found Monuments:**



**Location:** 40' Easterly of gravel rd.

**Tillamook County Surveyor office:** 1510 3<sup>rd</sup> Street Suite C, Tillamook, OR. 97141

**Party Chief:** Travis Porter, Tillamook County Survey Office

**Witnesses:** Michael Rice P.L.S. 86926, Tillamook County Surveyor  
Kael Pokliuha, Tillamook County Survey Tech

**Notes:** Digital images taken of monument and accessories.

**SURVEYOR'S SEAL**

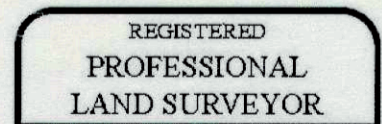

*Michael Rice*

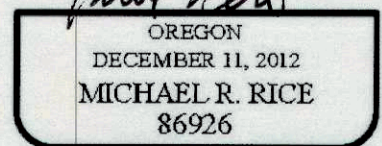

RENEWAL 12-31-2024

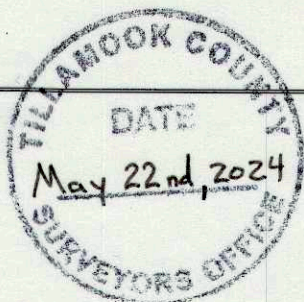

BOOK 8 201